



JCW Acoustic Deck 28/32 Laid on timber sub-floor

Ensure the building is weather tight before installing the floor. JCW Acoustic Deck 28/32 should only be installed when conditioned to its environment and ideally when its moisture content is the same as could be expected when in service.

JCW Acoustic Deck 28/32 is supplied tongue and grooved on all four edges and should be installed as a floating floor over a fixed substrate.

Laying JCW Acoustic Decking

1. Sweep floor clear of debris
2. Position JCW Perimeter Edging Strip at the base of all perimeter walls (this will be trapped in place by the JCW Acoustic Deck 28/32)
3. Remove tongues and grooves from the edges of JCW Acoustic Deck 28/32 where it meets the wall perimeter so as to ensure only square cut edges butt up to the JCW Perimeter Edging Strip. Do not compress the perimeter edging strip with the acoustic deck. This will both ensure acoustic integrity and allow expansion of the installation
4. Lay the JCW Acoustic Deck 28/32 in a brick-bond pattern with staggered short end joints. To ensure tight jointing, each tongue and groove is glued with JCW Waterproof PVA Adhesive
5. Any unavoidable gaps can be filled with JCW Acoustic Sealant
6. The JCW Perimeter Edging Strip is folded over the chipboard floor and trapped under the skirting board – the excess is then trimmed flush to the skirting board
7. The completed floor should not be walked on for at least 48 hours to ensure the adhesive has cured
8. Before any overlay finishes are fitted, it is essential the entire floor area is perfectly flat, clean and dry. Where necessary it is acceptable to sand off any raised joints before covering the floor. Vinyl sheet flooring or carpet may allow the board joints to telegraph through the overlay and will tend to show small irregularities in a floor surface than thicker patterned or textured surfaces. To avoid this problem a 6mm butt-jointed plywood overlay should be fitted, staggering joints so as to not coincide with those of the chipboard.

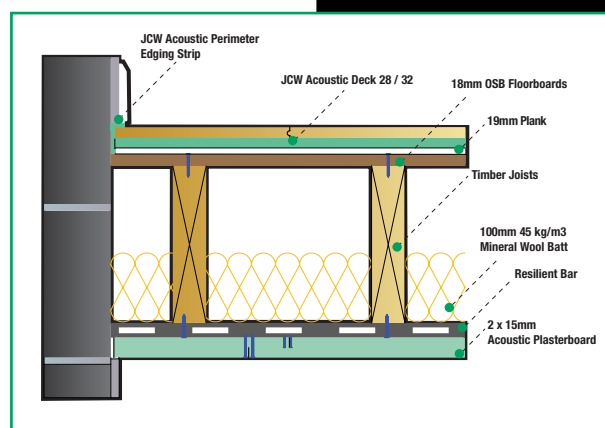

Installation Service

Our specialist acoustic installation teams are available across the UK. These skilled and experienced tradesmen understand acoustic materials and how to fit them quickly and correctly. The result is a cost effective service which ensures the acoustic integrity of your project.

For further details, call John C Wilkins Acoustic Supplies on 01204 548400

APPLICATIONS

- Offices • Meeting Rooms • Hotels • Conference Centres
- Leisure Centres • Schools • Restaurants • Showrooms