

Acoustic Deck 28/32

CONCRETE FLOOR OVERLAY BOARD

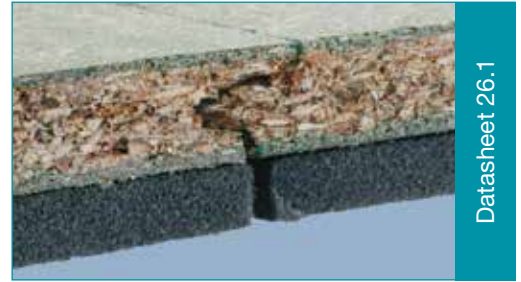

n55Plus



Datasheet 26.1

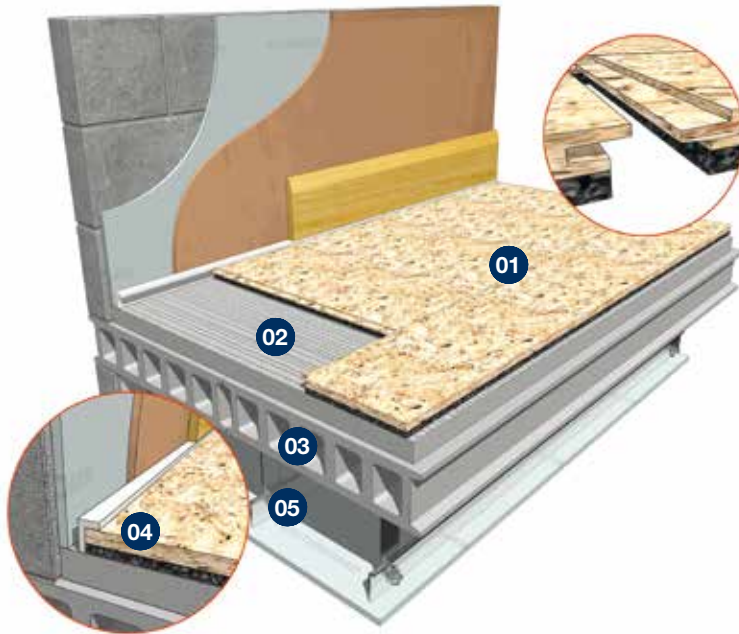

- 01** JCW Acoustic Deck 28/32
- 02** 40mm min directly applied sand & cement or proprietary screed (min 80kg/m²)
- 03** 150mm (min) Density 300kg/m² Concrete Floor
- 04** JCW L Shaped or Flat Perimeter Edging Strip detail
- 05** Metal Ceiling System with 100mm (min) void and 1 layer of 8kgs/m² gypsum based board

Product Code: Deck 28 - 1071 Deck 32 - 1074

Moisture Resistant 18mm or 22mm P5 T&G Chipboard with a pre-bonded 10mm resilient foam layer

Robust Detail (Registered Sites)

- Verified independent UKAS accredited laboratory test data meets the Robust Detail requirements. Pre-completion Testing is not required
- Deck 28/32 = FFT-5 Floor Types: E-FC-1,2 & E-FS-1 (Refer to Robust Details Handbook for full specification)

PCT/PT & Refurbishment

- Verified independent UKAS accredited laboratory test data is based on the floor structure illustrated above
- It is essential all components are correctly installed and detailed to meet the requirements where Pre-completion Sound Testing is required
- Deck ready for final floor finish e.g. laminates, carpets & carpet tiles (other finishes may require additional floor preparation)

Deck 28 Sheet Size: 28mm x 600mm x 2400mm (1.44 m²) **Weight:** 18 kgs

Deck 32 Sheet Size: 32mm x 600mm x 2400mm (1.44 m²) **Weight:** 21 kgs

Reduction in Impact Sound Transmission ΔL_w 18 dB

Method of Compliance

Robust Detail, PCT/PT (Scotland)

Ancillary Products

- 1130 JCW Flat Edging Strip (50 Lm x 150mm x 5mm) or 1170 JCW Universal L Shaped Strip (2 Lm x 53mm x 23mm)
- 1196 JCW Approved Adhesive (1 Litre)
- 1027 JCW Acoustic Sealant (310ml)

Domestic Dwellings | Offices | Hotels | Conference Centres | Leisure Centres | Schools | Restaurants | Showrooms



Unit 32-34 Waters Meeting Development
Britannia Way, Bolton, BL2 2HH

Sales helpline **01204 548400**
8.30am - 5.00pm Monday to Friday

sales@acoustic-supplies.com
www.acoustic-supplies.com

JCW Acoustic Decking floor panels are supplied in 2 standard board sizes dependHnt on the FRUHmaterial.

1) T&G Chipboard 2400 x 600mm

2) T&G Cement DVHG3DUWLFOHBoard RU700 200 x 600PP

All acoustic ERDUGare laid as a floating floor (i.e. no mechanical fixings). The boards must be NHSWdry and acclimatised at least 24 hours prior to installation7his will minimise any expansion or contraction after installation.

The subIORRjoists should be flat, dry, and free from all debris. Acoustic boards are best laid towards the end of the project to protect from general trades, high floor loadings and moisture leading to expansion.

- The floor area/s to be overlaid should be carefully planned prior to commencing installation to minimise wastage. There are two board types; **1) 2YHUODRDUGV** onto an existingRUHZ sub-floorRU UHFWR-RLVW,LUHFWRMRLVWLDWOODWLRWVKHERD EHDLGRWRIDWRUOHHOOGMRLVWLVKHRSSRLVHGLUHFWLRRIWKHMRLVWVHVLWVKDWDOOERDUGHGVILVKRDMRL DGGLWLRDOVSRUWVPDEHUHTUHGUHFWRMRLVWERDUGVFDDOVREHODLGRWRHVLWLRUJZVEIORRUVDVDBBUODVRO
- (VJHWKDWDOOZDOOVNIDFHVDUHSUHSUDUHGSDVWHUERDUGHGDKRUSODVWHUVNLPPHGGRZWRWKHOHORIWKHVEIORRU IDFLDLWLDWVHWKHVDWGHGWUDVPLVLRVIVRSDWKHZDOOHGJHV
- SSORP-83HULPHWHU(GJL6WULSRU -876KDSHG3HULPHWHU(GJL6WULSV WRWKHEDVHRIDOOSHULPHWHUZDOOVDOOR WKHHEHVVIDRPWREHIROGHGRFDGWDUSSHGSHUWKHVNLUWLDERDUGWKHHEHVVLVWKHMLULPPHGWRLKVKIOWKWRWKHIU WKHVNLUWLDERDUGMLDVKDUSWULPPLNKH
- 5HPRDVRVVDVWVKHZDOOHGJHVWKHEVDFULEHWKHILUVVFRUJUERDUGLWRSODFHDGEMWBSGRWFRPSUHVVWRWKH -83HULPHWHU(GJL6WULSD007ERDUGMRLVVPVWEHIDODGKHVLEHREHGVLROUHFPPHGHGDKHVLN7KHODVWERDUG LMKHILUVVURZVKRDEHFVWROHVKDKGKRIIFWFDUULHGIRUZDUGWREHJLWKHVHFRURZ
- 3URFHGZLWKVKHVHFRDGEVFFHVLEHURZVHVLWVKDWDOOERDUGMRLVVDUHVVDDJHJHUHG7KHODVURZRIERDUGVZLOO DFFNDWHFVWLVFULELWREMWWSRWKHZDOOPLBUJDSVEHWZHHWKH-83HULPHWHU(GJL6WULSDGWKHDFRVLFRDUG VKRDEGHILOOHGZLWK-83RVLWF6HDODV,WLVLPSHUDWLVKDWKWH-83HULPHWHU(GJL6WULSDVWVHGRUGHUWR PDLVDLWKHDFRVLFLVHJULWDEGWRSURRGGHDOORZDFHIRUHSDVLR
- AWPDLVWUDEHGRRUZDVKHDFRVLWLFHFVVKRDEGWEHFRVLMZLWKDGMRLKDUHDV/HDEIDPPJDSWVKHGRRUWKUHVKROG EHWZHHWKHDKMRLKDFRVLFRDUGVDEILOOZLWK-83RVLWF6HDODV7KLVDVFLRZLOOHVJHWKDWWKHDFRVLFLVHJULW PDLVDLVHZLWKLWKHURRPWKDVLVEHLVRSWHVWHG
- The finished floor should not be walked on for a period of 24 hours to allow the adhesive to cure undisturbed. **NOTE; PVAadhesive will not cure in temperatures below 5° Celsius.** (VJHWKDWWKHERDUGMRLVWDGKHVLEKDVIOORHGSULRUWRRIUODKDLDOIORR FRUL

Any penetrations through the acoustic floor and beneath the separating ceiling must be correctly detailed and dealt with on a site by site basis.

Further assistance is available via our Technical Helpline.

Disclaimer: The product and installation information contained in this Data Sheet and General Installation Guide is to the best of our knowledge correct. Please contact us or the relevant product manufacturer directly prior to starting works, for the latest information to enable confirmation of the specification.

Please Note: We recommend seeking appropriate advice from the relevant manufacturer of the final floor finish with regards to any additional preparation that may be required.

