

Acoustic Deck 28/32

ECONOMICAL OVERLAY FOR
TIMBER FLOORS

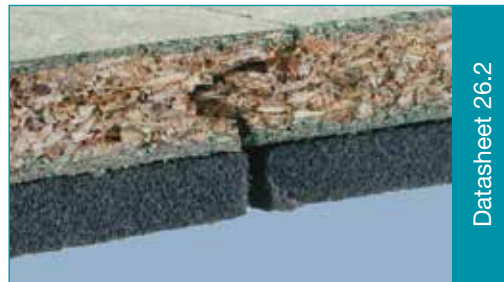

Datasheet 26.2

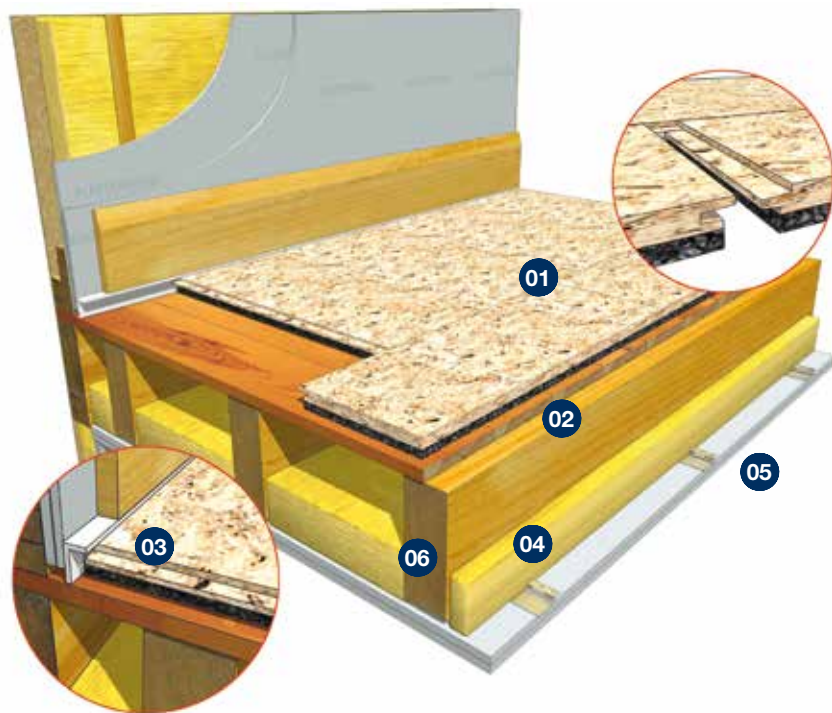

- 01 JCW Acoustic Deck 28/32
- 02 Existing Subfloor
- 03 JCW L Shaped or Flat Perimeter Edging Strip detail
- 04 100mm x 45kgs/m³ Acoustic Slab
- 05 Resilient Bars and 2 layers x 15mm Acoustic Plasterboard
- 06 225mm depth Timber Joists

Product Code: Deck 28 - 1071 Deck 32 - 1074

Economical overlay or direct to joist board

Acoustic Floating Floor: 18mm or 22mm T&G P5 chipboard with a pre-bonded 10mm foam resilient layer.

Refurbishment

- Low cost product ideal for both general and new domestic separating floor upgrades in lofts and extensions etc
- Good Impact and Airborne sound reduction
- Ideal for floated wood, laminate, carpets/carpet tiles. Additional floor preparation may be required for tiling and vinyl overlays

PCT/PT

- Economical system for Conversion projects
- It is essential the recommended components shown above are used and correctly installed/detailed to meet the requirements where Pre-completion Sound Testing is required
- Deck ready for final floor finish e.g. laminates, carpets & carpet tiles (other finishes may require additional floor preparation)

Deck 28 Sheet Size: 28mm x 600mm x 2400mm (1.44 m²) **Weight:** 17.8 kgs

Deck 32 Sheet Size: 32mm x 600mm x 2400mm (1.44 m²) **Weight:** 21.8 kgs

UKAS laboratory test data based on Direct to Joist construction: **Impact:** 56 dB Ln,w **Airborne:** Rw + Ctr 52 dB

Method of Compliance

PCT/PT (Scotland)

Ancillary Products

- 1130 JCW Flat Edging Strip (50 Lm x 150mm x 5mm)
- 1170 JCW Universal L Shaped Strip (2 Lm x 53mm x 23mm)
- 1196 JCW Approved Adhesive (1 Litre)
- 1027 JCW Acoustic Sealant (310ml)

Domestic Dwellings | Offices | Hotels | Conference Centres | Leisure Centres | Schools | Restaurants | Showrooms



Unit 32-34 Waters Meeting Development
Britannia Way, Bolton, BL2 2HH

Sales helpline **01204 548400**
8.30am - 5.00pm Monday to Friday

sales@acoustic-supplies.com
www.acoustic-supplies.com

