

# Acoustic Impacta Mat 4551

CONCRETE FLOOR SOFT COVERING MAT

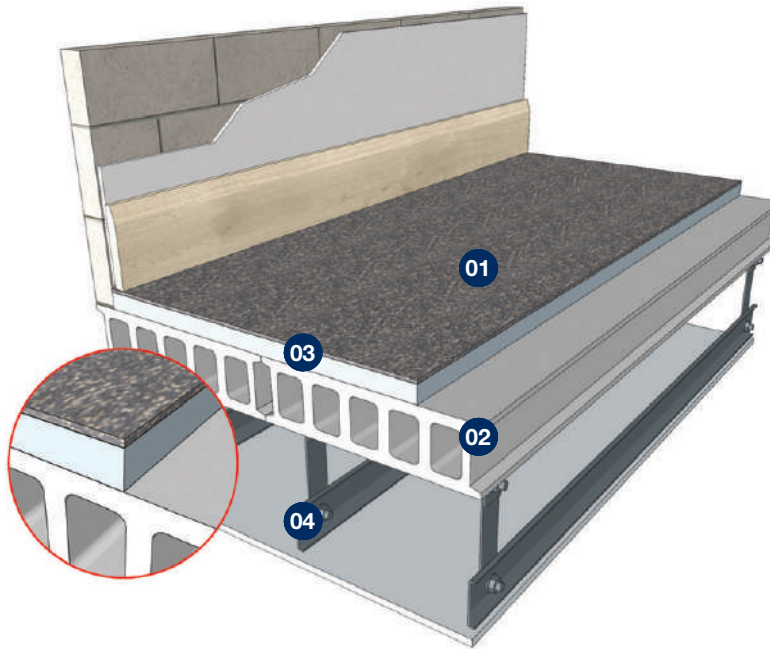

Datasheet 30



- 01 JCW Acoustic Impacta Mat 4551
- 02 150mm (min) Concrete Floor
- 03 65mm sand & cement screed layer or 40mm proprietary screed (min 80kg/m<sup>2</sup>)
- 04 Metal Ceiling System with 100mm (min) void and 1 layer of 8kgs/m<sup>2</sup> gypsum based board



**Product Code:** 3.0mm - 1018 4.5mm - 1019

Recycled rubber bonded with cork granulate: Impact sound bonded surface layer for concrete floors

#### Robust Detail (Registered Sites)

- Verified independent UKAS accredited laboratory test data that meets Robust Detail requirements. Pre-completion testing is not required
- Acoustic Impacta Mat 4.5mm = Bonded Resilient Floor Covering for floor type: E-FC-8 (Refer to Robust Details Handbook for full specification)

#### PCT/PT & Refurbishment

- Verified independent UKAS accredited laboratory test data is based on the floor structure illustrated above
- Impacta Mat 4.5mm when fully bonded to the sub-floor meets the Building Regulation requirements for Impact Reduction on all pre-cast concrete/beam & block floors that have a minimum mass of 300kg/m<sup>2</sup>
- Impacta Mat 3mm provides a good Impact Reduction for new and refurbishment projects
- Ready for final floor finish e.g laminates, carpets & carpet tiles (other finishes may require additional floor preparation)

**Roll Sizes:** 3.0mm x 1050mm x 20m (21.00 m<sup>2</sup>) Weight: 44.5kg  
4.5mm x 1050mm x 10m (10.50 m<sup>2</sup>) Weight: 34.5kg

Reduction in Impact Sound transmission  
4.5mm  $\Delta L_w = 21$  dB 3.0mm  $\Delta L_w = 18$  dB

#### Method of Compliance

Robust Detail, PCT/PT (Scotland)

#### Ancillary Products

1027 JCW Acoustic Sealant (310ml)  
1022 JCW Impacta Adhesive

Domestic Dwellings | Offices | Hotels | Conference Centres | Leisure Centres | Schools | Restaurants | Showrooms



Unit 32-34 Waters Meeting Development  
Britannia Way, Bolton, BL2 2HH

Sales helpline **01204 548400**  
8.30am - 5.00pm Monday to Friday

sales@acoustic-supplies.com  
[www.acoustic-supplies.com](http://www.acoustic-supplies.com)

## Guidance notes for installation of JCW Impacta Mat 4551: 3mm and 4.5mm

### Preparation:

1. It is important that the sub-floor is dry, clean, and free of dust, debris and adequately prepared to enable a good adhesive bond. The level of floor preparation required will be determined by the final floor finish specified.
2. JCW Impacta Mat 4551 stretches slightly when rolled up. Unroll and leave 3-4 hours prior to cutting & fitting.

### Laying JCW Impacta Mat 4551:

BS 8203; 2017 and the following guidelines should be observed.

1. JCW Impacta Adhesive has been tested and is suitable for bonding JCW Impacta Mat 4551 to the majority of base floor types that may be considered. (JCW Impacta Adhesive available on request).
2. When laying JCW Impacta Mat 4551 into the adhesive ensure any air is removed by pressing from the centre outwards.
3. Roll JCW Impacta Mat 4551 from end to end & side to side using a 68kg flooring roller.
4. Cut & Trim JCW Impacta Mat 4551 using a sharp knife and straight edge. Ensure all edges are butt jointed.
5. On completion of the floor area wait for 30mins and roll the floor again.
6. The adhesive must be allowed to fully cure prior to overlaying of floor finishes, trafficking and loading in.
7. **Plasticiser Migration:** JCW Impacta Mat 4551 has been tested and is considered resistant to plasticiser migration according to the SATRA test report. The full report is available upon request.

**Please note:** the above installation notes are for guidance only and may require further verification via a specialist adhesive or flooring manufacturer.

**Disclaimer:** The product and installation information contained in this Data Sheet and General Installation Guide is to the best of our knowledge correct. Please contact us direct, prior to starting works, for the latest information to enable confirmation of the specification.

**Please Note: We recommend seeking appropriate advice from the relevant manufacturer of the final floor finish with regards to any additional preparation that may be required.**