

Acoustic Cradle Levelling System

CONCRETE FLOOR CRADLE & BATTEN

nsPlus

Datasheet 52

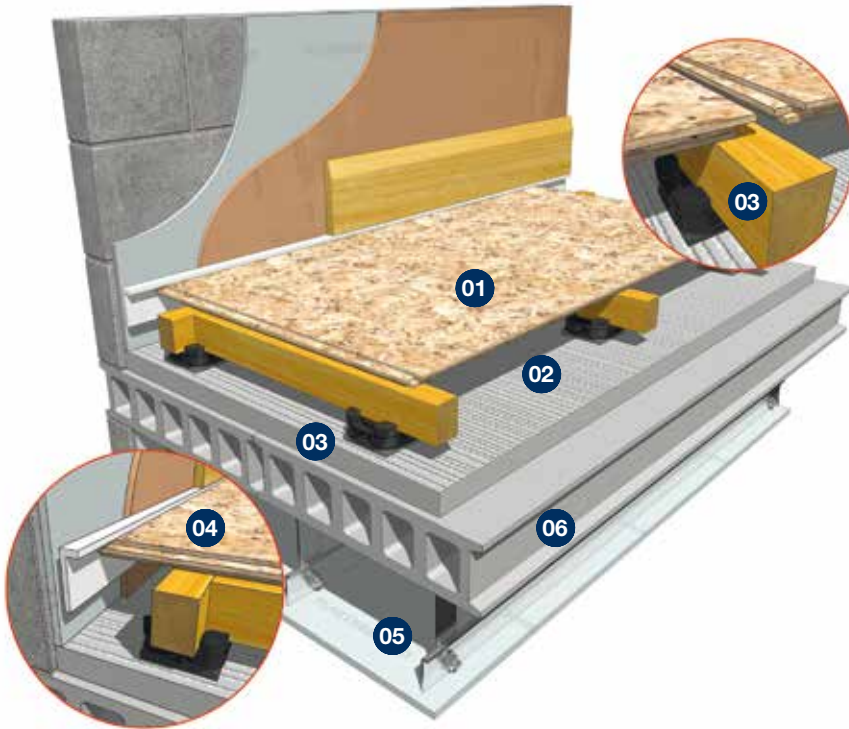

- 01 Minimum 18mm t&g flooring board
- 02 40mm min directly applied sand & cement or proprietary screed (min 80kg/m²)
- 03 JCW Acoustic Cradle Levelling System
- 04 JCW L Shaped or Flat Perimeter Edging Strip detail
- 05 Metal Ceiling System with 100mm (min) void and 1 layer of 8kgs/m² gypsum based board
- 06 150mm (min) Concrete Floor

Note: Beam & Block floor type E-FC-7 requires Mineral Wool Fibre between the battens of 25mm (min) 10-36 kg/m³.

CONTACT TECHNICAL DEPARTMENT FOR GUIDANCE ON CRADLE AND BATTEN CENTRES

JCW Acoustic Cradle Levelling System

FFT-2 Resilient Cradle and Batten System

Robust Detail (Registered Sites)

- Verified independent UKAS accredited laboratory test data meets the Robust Detail requirements. Pre-completion Testing is not required
- Acoustic Cradles = FFT-2 Floating Floor Types: E-FC-1, E-FC-2 & E-FS-1 (Beam & Block floor type E-FC-7 floor specification varies, refer to Robust Details Handbook for full specification)

PCT/PT & Refurbishment

- Verified independent UKAS accredited laboratory test data is based on the floor structure illustrated above
- It is essential all components are correctly installed and detailed to meet the requirements where Pre-completion Sound Testing is required

Reduction in Impact Sound Transmission: ΔL_w 28 dB

Method of Compliance

Robust Detail, PCT/PT (Scotland)

Ancillary Products

1130 JCW Flat Edging Strip (50 Lm x 150mm x 5mm) or
1170 JCW Universal L Shaped Strip (2 Lm x 53mm x 23mm)
1196 JCW Approved Adhesive (1 Litre)
1027 JCW Acoustic Sealant (310ml)

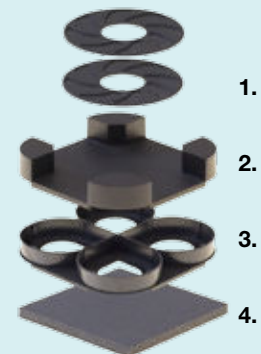

1. 2mm Packers - Product Code: 1025
2. Acoustic Cradle - Product Code: 1023
3. 20mm Riser - Product Code: 1026
4. 10mm Acoustic Rubber Pad (Supplied with Product Code: 1290)

Domestic Dwellings | Offices | Hotels | Conference Centres | Leisure Centres | Schools | Restaurants | Showrooms



Unit 32-34 Waters Meeting Development
Britannia Way, Bolton, BL2 2HH

Sales helpline **01204 548400**
8.30am - 5.00pm Monday to Friday

sales@acoustic-supplies.com
www.acoustic-supplies.com

Recommended Cradle Spacings

Flooring Type	Batten Dimensions	Cradle Centres	Batten Centres
18mm Chipboard	47 x 47mm	600mm	400mm
22mm Chipboard	47 x 47mm	600mm	600mm max
18mm Chipboard	21 x 47mm	300mm	400mm
22mm Chipboard	21 x 47mm	300mm	600mm max

(All dimensions quoted above are for planed timber)

Technical Specifications

- The **Acoustic Rubber Pad**, 10mm thick, is manufactured from recycled rubber tyres.
- The **Acoustic Cradle Levelling System** is manufactured from recyclable plastics. They provide height increments from 11mm, excluding timber batten, when used on their own. The cradle design also allows the system to accept four batten ends, a useful four way support method.
- Adding the interlocking **Riser** provides 20mm height increments and these can be used in multiples to enable major level differences to be accommodated.
- The **Packing Shims**, which are 2mm thick and fit snugly within the cradle, permit the ultimate flexibility in height adjustment.
- The system is flexible enough to be able to accept batten heights from 21mm to 100mm (please ask for details if extra heights are required).
- It is recommended that a 25mm thick mineral wool quilt (10- 36kg/m³ density) is placed between the cradles and battens to further enhance acoustic performance.
- Tests have shown that when the quilt is omitted, the system is still capable of satisfying the minimum requirements of the Building Regulations.
- Where high thermal insulation is a priority the self locking Level Pod Cradle can be stacked onto several Risers to provide a significant void for the application of mineral wool insulation.
- Final floor finishes can be anything required including low cost 18mm thick T&G chipboard, plywood or hardwood.
- To ensure the acoustic integrity and performance of the system installation, a 5mm thick closed cell polyethylene **JCW Perimeter Edging Strip** should be fitted between the wall and the finished floor surface.
- Any skirting boards should be fixed isolated from the floor by the **JCW Perimeter Edging Strip**.

Summary

- Simplicity itself.
- Only a maximum of four different components needed for any application.
- Only one size of packer needed.
- Multiple height possibilities achievable.
- No time wasted calculating quantities needed on site.
- Made from environmentally sensitive, recyclable materials.
- Can alternatively be used as a system to accommodate services or as a raised floor system to provide the required amount of underfloor space.



Building Regulations

Compliance with Approved Document E (England & Wales) can be shown by Pre-Completion Testing on site.

Compliance with Robust Details FFT-2 Impact Sound Improvement test data.

Compliance with Section 5 (Scotland) can be shown by Performance Testing on site.

Impact Sound Insulation

The table below represents a comparison of the impact sound insulation offered by the floating floor system as tested on a concrete floor. The tests were carried out on a 150mm deep hollowcore precast concrete plank with a 20mm sand and cement screed total mass of 335kg/m². The test sample consisted of a 18mm tongue and groove chipboard with 45 x 45mm battens on the JCW Level Pod Cradles with 50mm mineral wool insulation between battens. Tests were carried out by Sound Research Laboratories, UKAS accredited test laboratory No. 0444 on the 24th February 2005, Test Report No. C/04/5L/3162/1a.

Acoustic Performance dB

Concrete Base Floor (Ln,w)	79 dB
JCW Acoustic Cradle Levelling System (Ln,w)	51 dB
Improvement (Robust Details Part E minimum requirement: +17)	+28 dB

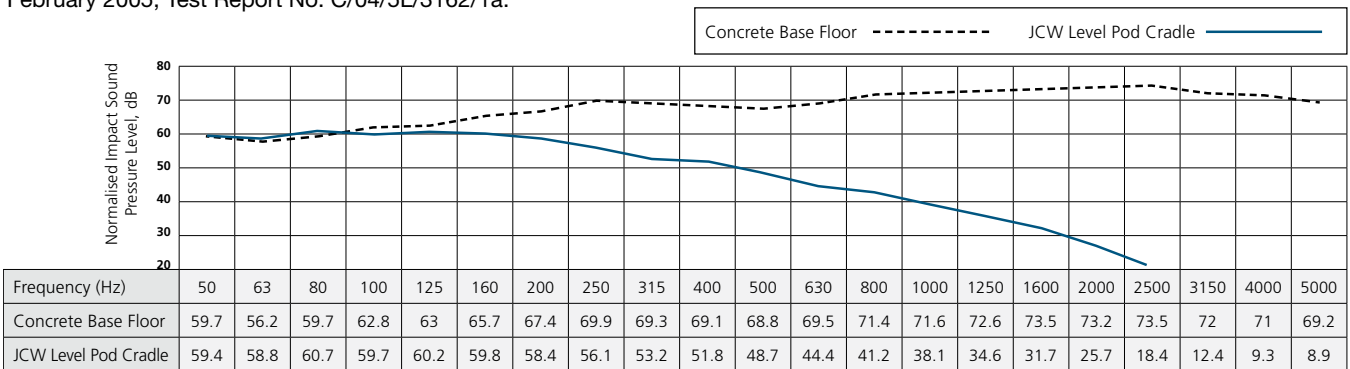

Airborne Sound Insulation

The table below represents a comparison of the airborne sound insulation offered by the floating floor system as tested on a concrete floor. The tests were carried out on a 150mm deep hollowcore precast concrete plank with a 20mm sand and cement screed total mass of 335kg/m². The test sample consisted of a 18mm tongue and groove chipboard with 45 x 45mm battens on JCW Level Pod Cradles with 50mm mineral wool insulation between battens. Tests were carried out by Sound Research Laboratories, UKAS accredited test laboratory No. 0444 on the 24th February 2005, Test Report No. C/04/5L/3162/1a.

Acoustic Performance dB

Concrete Base Floor (Rw + Ctr)	51 dB
JCW Level Pod Cradle (Rw + Ctr)	55 dB
Improvement (Airborne test data not required by Robust Details Part E)	+4 dB

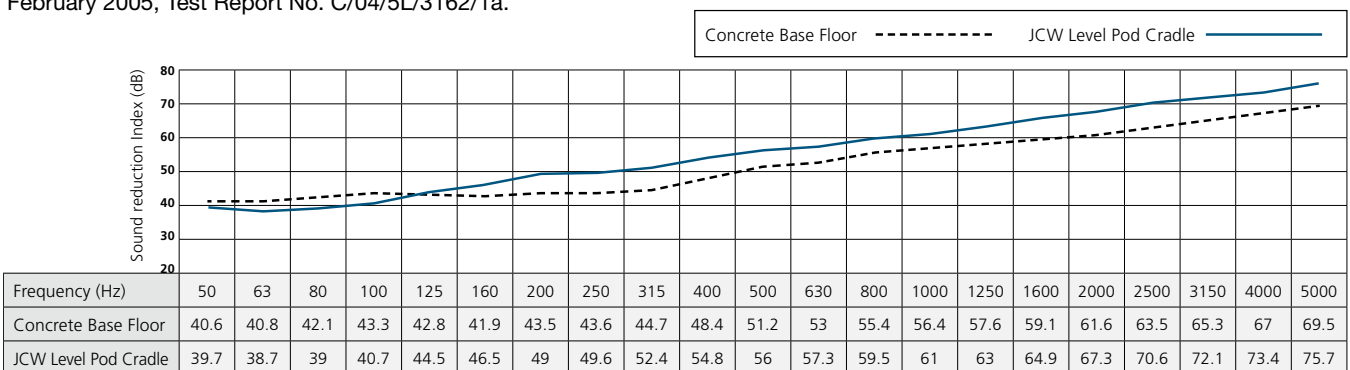

Unique Levelling System for both external and internal sub-floors

The JCW Acoustic Level Pod Cradle has been developed as a totally flexible way to quickly and easily level uneven sub-floors and will provide good acoustic separation between the base floor.

Whilst the system is primarily used internally as a Robust Details acoustic solution for uneven concrete sub-floors, its unique stacking technology and rot proof construction make the system ideally suitable for creating a level base to carry every type of external decking application, including balconies and bridge decks.

The system has been successfully installed by builders and developers across a range of external commercial, domestic and leisure applications where it provides a level base which is both robust and durable for the application of treated timber support battens and all types of specialist and proprietary decking overlay boards.

The JCW Level Pod Cradle System has the strength to easily manage all widths, thicknesses and lengths of structural timber deck boards.



Summary

- Simplicity itself, quick and easy to install.
- Multiple height possibilities achievable.
- Weather proof, rot proof, damp proof.
- Strong, robust, flexible.
- No on site waste.
- Made from environmentally sensitive, recyclable materials.
- Can be used as a system to accommodate services or as a raised floor system to provide underfloor space.

Case Histories

Telford Homes: Tredegar Road, Bow, London

Telford Homes: Papermill Place, Walthamstow, London

About JCW Acoustic Supplies

JCW Acoustic Supplies is renowned for the high quality of its acoustic flooring products and the professionalism of its support and product development teams.

We can provide all the information and advice you need to ensure all technical and legal requirements are satisfied.

For further details, call Sales at JCW Acoustic Supplies on the Sales helpline number below

Disclaimer: The product and installation information contained in this Data Sheet and General Installation Guide is to the best of our knowledge correct. Please contact us direct, prior to starting works, for the latest information to enable confirmation of the specification.



Domestic Dwellings | Offices | Hotels | Conference Centres | Leisure Centres | Schools | Restaurants | Showrooms



Unit 32-34 Waters Meeting Development
Britannia Way, Bolton, BL2 2HH

Sales helpline **01204 548400**
8.30am - 5.00pm Monday to Friday

sales@acoustic-supplies.com
www.acoustic-supplies.com