

Acoustic Noiseclip

ACOUSTIC ISOLATION CLIP

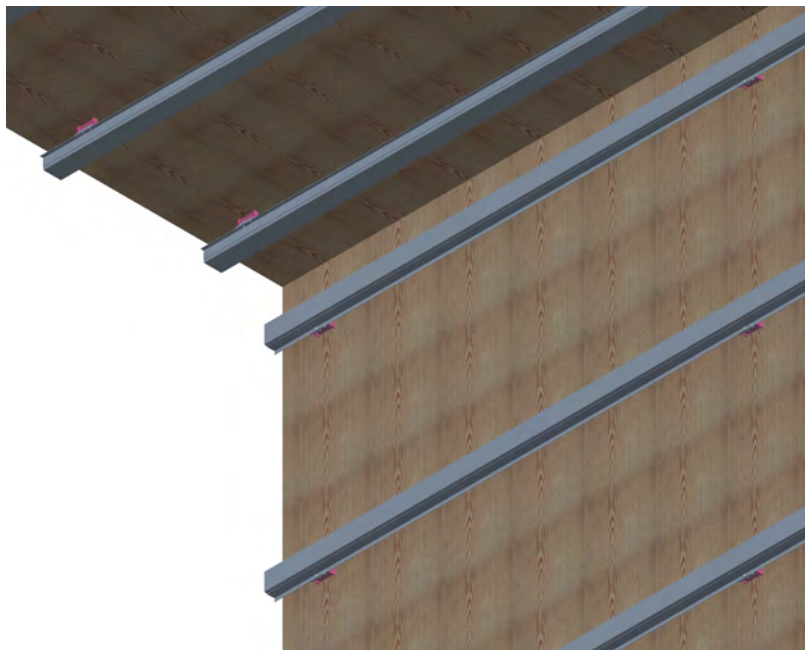

Datasheet 97



- Noiseclip shown installed to underside of existing joists
- Also applicable to increase performance of existing party walls
- Noiseclip has been specifically designed to directly interface with the standard MF5 'top hat' metal furring channels which are widely available in the UK

Product Code: 1326	
Acoustic clip and channel system	
Ideal improvement solution when no access to floors above	
<ul style="list-style-type: none"> • Suitable for new or existing joists. • Uses industry standard MF5 channel • Ideal for home improvement situations • Airborne and Impact noise improvement 	
Weight: 0.079kg	Size: For detailed dimensions please see drawings overleaf
Airborne Improvement of up to 18dB & Impact Reduction up to 20dB when used with 2 layers of 15mm Soundblock Plasterboard	
Key Benefits Easy to install Suitable for competent DIY enthusiasts & general tradesmen Cost effective solution	Ancillary Products 1027 JCW Acoustic Sealant (310ml) Various JCW Fire & Acoustic Socket Box Inserts (for walls)

Domestic Dwellings | Offices | Hotels | Conference Centres | Leisure Centres | Schools | Restaurants | Showrooms



Unit 32-34 Waters Meeting Development
Britannia Way, Bolton, BL2 2HH

Sales helpline **01204 548400**
8.30am - 5.00pm Monday to Friday

sales@acoustic-supplies.com
www.acoustic-supplies.com

Tools/Accessories required

- Screwdriver
- Hacksaw or other suitable implement for cutting channel to correct length
- Frame fixings for brick & block walls or screws for timber
- JCW Acoustic Sealant

Installation Notes

1. Existing plasterboard should be removed from ceiling or walls leaving existing studs or joists visible. On walls where no studs are already in place new timber studs should be installed.
2. Fixing of the Noiseclip is quick and easy thanks to a single central 5.0 x 50mm screw. Clips should be installed 150mm from the perimeter and subsequently no further apart than 450mm along each joist or stud frame.
3. Noiseclips should be installed onto alternate joists at a maximum spacing of 1200mm.
4. The MF5 'top hat' channel is simply pressed in to place and secured via 2x screws for extra security.
5. Secure the first layer of 15mm Soundblock plasterboard into the MF5 channel using a 25mm metal stud plasterboard screw. The second layer should be secured using a 42mm metal stud plasterboard screw.
6. If an alternative thickness of plasterboard is used care should be taken to ensure that screws of a relative length are used so that the screws do not come into contact with either the joists or timber stud walls.
7. Once both layers of plasterboard are in place the perimeter along with any gaps should be sealed using JCW Acoustic Sealant.
8. Once installed and sealed the boards are now ready for "skimming" or decorating as necessary.

DRAWINGS

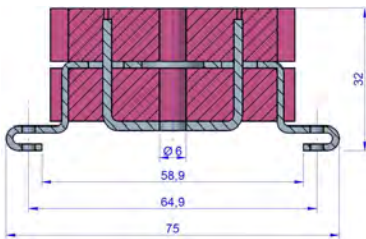

SECTION A-A

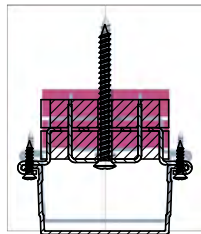

MF5 FURRING CHANNEL

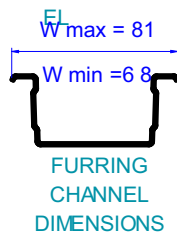
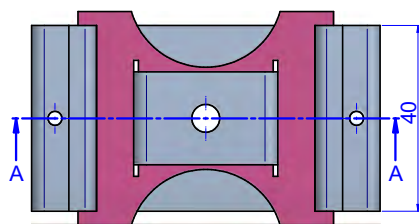

Disclaimer: The product and installation information contained in this Data Sheet and General Installation Guide is to the best of our knowledge correct. Please contact us direct, prior to starting works, for the latest information to enable confirmation of the specification.

Domestic Dwellings | Offices | Hotels | Conference Centres | Leisure Centres | Schools | Restaurants | Showrooms



Unit 32-34 Waters Meeting Development
Britannia Way, Bolton, BL2 2HH

Sales helpline **01204 548400**
8.30am - 5.00pm Monday to Friday

sales@acoustic-supplies.com
www.acoustic-supplies.com